

BODY/UNIT:

Material: Polyethylene Blend
Weight: 18" Depth: 14.0 lbs

24" Depth: 18.0 lbs
30" Depth: 21.0 lbs
36" Depth: 25.0 lbs
48" Depth: 35.0 lbs
60" Depth: 49.0 lbs

Standard Color: Black with White Interior
Mouseholes: 2

EXTENSIONS:

Material: Polyethylene Blend
Weight: 3" Depth: 4.5 lbs

6" Depth: 6.5 lbs
12" Depth: 10.5 lbs
22" Off Grade: 6.5 lbs

Standard Color: Black with White Interior

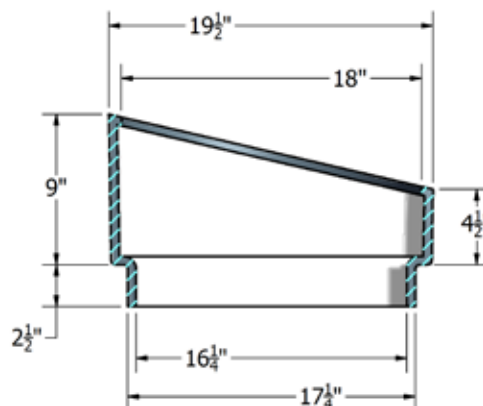
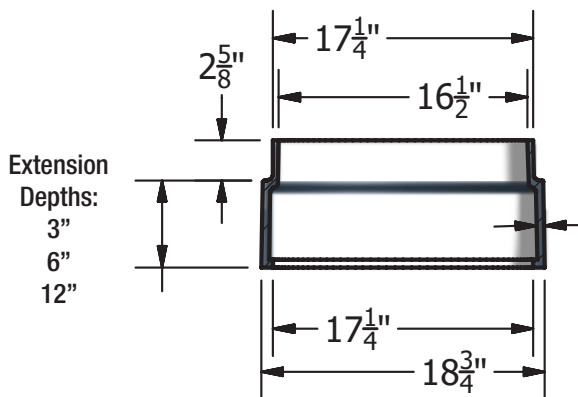

Note:
Actual load rating is determined by
the box and cover combination

Weights and dimensions may
vary slightly

18B

Options:

Available Plastic Covers:

MSIL1 Plastic Cover (for use with cast iron frame)

Available Cast Iron Covers:

Flush Cast Iron Lid with Cast Iron Ring (2 Piece)

T Cast Iron Cover with Cast Iron Ring (2 Piece)

Flat Frame Cast Iron Cover

Drop In (for use with cast iron frame)

Add On Options:

Touch Read Hole

ERT Holder (MSIL1 Only)

Thermo-Pak

Locking Options:

Penta Nut (Small or Large)

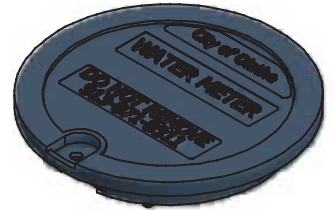

MSIL1

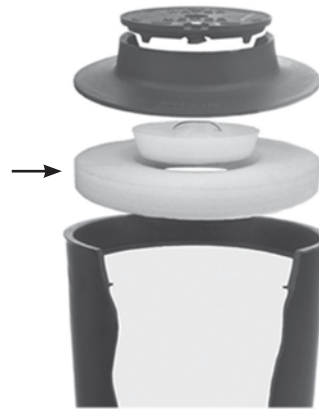

Thermo Pak

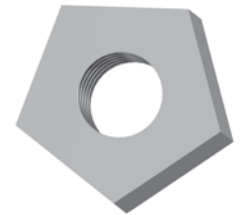

Penta Nut Detail

Raw Material Specifications:

- Meter Boxes are high-density Polyethylene, one-piece molded construction
- Wall thickness minimum .550"
- Vertical load rating minimum 15,000 lbs.
- Sidewall loading of 200 lb side load, applied with a 4" X 4" plate.
- Multi-layer wall construction
- Black exterior surface to provide UV protection
- Gray foaming for strength and insulating value
- White interior surface for ease of meter reading
- Manufactured by Oldcastle Precast Enclosure Solutions

Cast Iron Meter Ring and Lid Specifications:

- Made of cast iron conforming to ASTM A48 standards and marked with country of origin
- Coated with a factory applied water based asphalt paint
- Castings are ground smooth and cleaned by shot blasting, uniform quality, free from sand holes, shrinkage, cracks and other surface defects, with a dimensional tolerance of +/- 1/16" per foot based on the accepted foundry tolerances outlined in the Iron Castings Handbook published by the American Foundry Society.

OPES Load Rating Key:

- Light Duty : Pedestrian/Greenbelt
- Medium Duty : Incidental, Non-deliberate Traffic
- Heavy Duty : Incidental, Non-deliberate Traffic
- Traffic : Continuous Roadway Traffic

Note:

Actual load rating is determined by the box and cover combination. Weights and dimensions may vary slightly

All information contained on this sheet is current at the time of printing. Because of Oldcastle Precast, Inc.'s policy of ongoing research and development, the Company reserves the right to discontinue or update product information without notice.